

Guide to Reading An Assessor's Plat Map

A Parcel Number

Always in a small circle (occasionally in an oval).

B Book and Page Circle

Indicates what map page (# below the line) adjoins our map and in some cases which Assessor's Book (# above the line).

C Lot Number

Never circled; shows the subdivision lot number of the property.

D "Picture Corner"

Shows the exterior corners of subdivision map boundaries as shown on the map.

E Page Number

Of the Assessor's Book, Page & Picture Corner 1#. This is the full 3-digit number (coinciding with column one in the changes box); always in an oval.

F Acreage Figures

A decimal number with AC following. Not always accurate. Use only as estimate.

G Distances and Bearings

Data on borders of the map. This data is from recorded deeds or surveys.

H Lower Right

Brief legal description of the properties included on this page.

I North Arrow

Will not always be pointing up. SCALE: Is useful if map has been printed to proper size.

J Assessor's Book Number

Followed by first two digits of the Page Number, located in the upper right corner next to arrow.

K Changes Box

Provides the history of the map page.

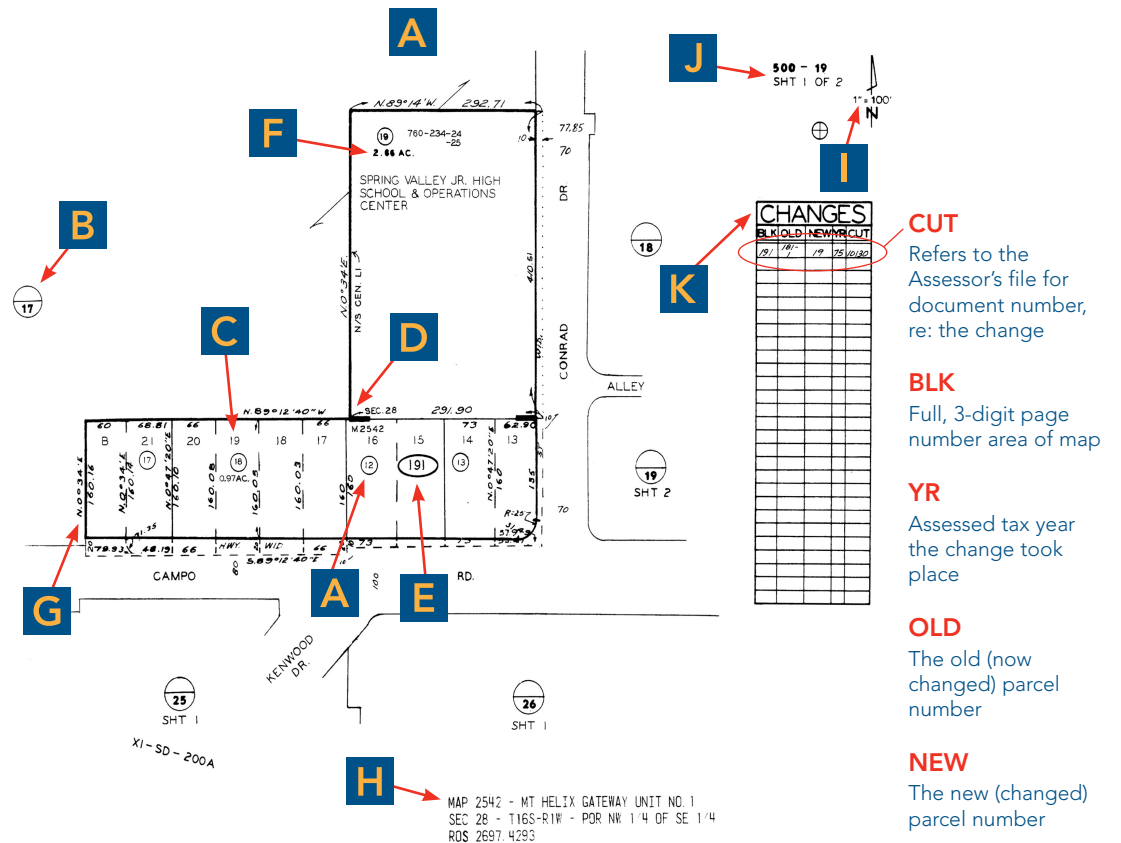

CUT
Refers to the Assessor's file for document number, re: the change

BLK
Full, 3-digit page number area of map

YR
Assessed tax year the change took place

OLD
The old (now changed) parcel number

NEW
The new (changed) parcel number



Vicki Reeves

Riverside Sales Manager
vreeves@firstam.com
Office 951-787-1700 CUSTOMER SERVICE 866-748-3924
www.firstamriverside.com



First American Title™

800.451.0454 | www.firstam.com